

DIRECTIONS FOR GUESTS TO SET UP THEIR ACCOUNTS

ONCE THE TEAMS GROUP IS CREATED BY THE ORGANIZER, GUESTS WILL BE SENT AN EMAIL INVITATION TO JOIN THE MEETING – BUT...

THEY HAVE TO SET UP A MICROSOFT ACCOUNT FIRST

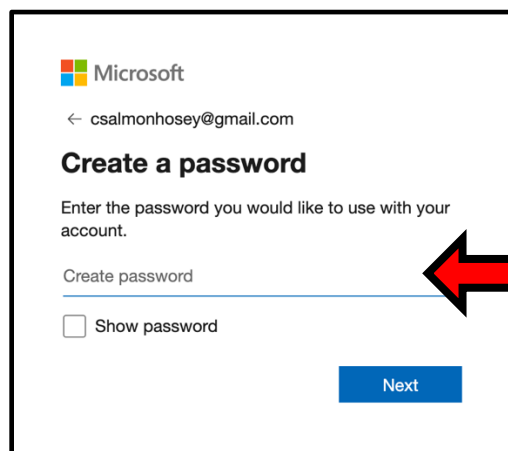
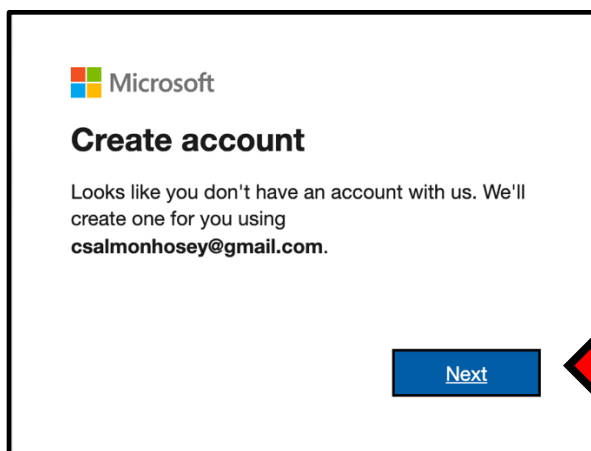
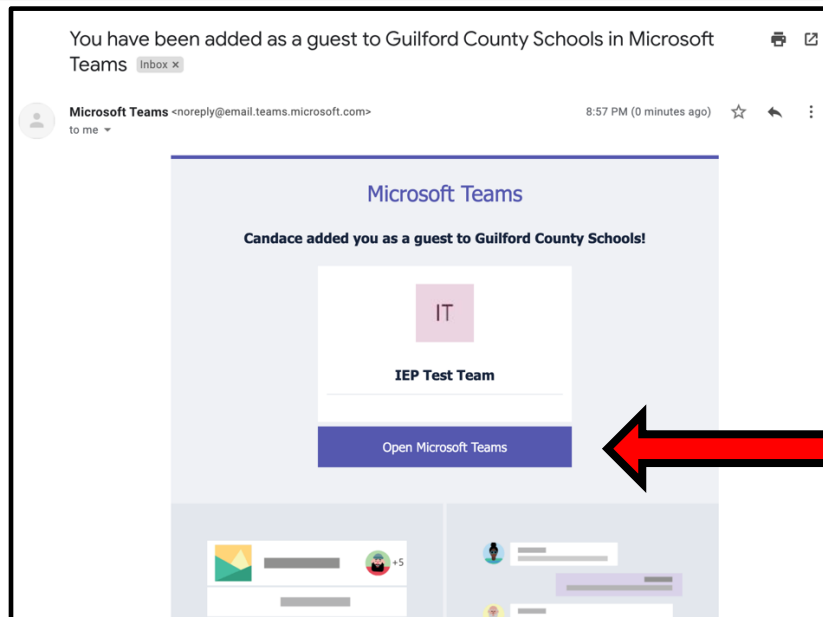

Microsoft

← csalmonhosey@gmail.com

Create account

We need just a little more info to set up your account.

Country/region
United States

Birthdate
Month Day Year

Next

Verify your email address Inbox x

Microsoft account team <account-security-noreply@accountprotection.microsoft.com> 8:59 PM (0 minutes ago) to me

Microsoft account

Verify your email address

To finish setting up your Microsoft account, we just need to make sure this email address is yours.

To verify your email address use this security code: **3547**

If you didn't request this code, you can safely ignore this email. Someone else might have typed your email address.

Thanks,
The Microsoft account team

Reply Forward

GUEST WILL CHECK THEIR EMAIL ACCOUNT TO RETRIEVE THE CODE TO VERIFY THEIR EMAIL

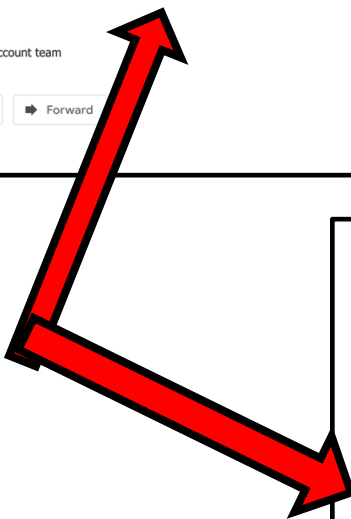

Microsoft

← csalmonhosey@gmail.com

Verify email

Enter the code we sent to **csalmonhosey@gmail.com**. If you didn't get the email, check your junk folder or [try again](#).

3547

I would like information, tips, and offers about Microsoft products and services.

Choosing **Next** means that you agree to the [Microsoft Services Agreement](#) and [privacy and cookies statement](#).

Next



← csalmonhosey@gmail.com

Create account

Before proceeding, we need to make sure a real person is creating this account.



New

Audio

Enter the characters you see

wjldpxwx

Next



THE GUEST WILL VERIFY THEY ARE NOT A ROBOT AND REVIEW/ACCEPT PERMISSIONS OF A GUEST



csalmonhosey@gmail.com

Review permissions

G

Guilford County Schools gcsnccom.onmicrosoft.com

This resource is not shared by Microsoft.

The organization Guilford County Schools would like to:

- ✓ Sign you in
- ✓ Read your name, email address, and photo

You should only accept if you trust Guilford County Schools. By accepting, you allow this organization to access and process your data to create, control, and administer an account according to their policies. **Guilford County Schools has not provided a link to their privacy statement for you to review.** Guilford County Schools may log information about your access. You can remove these permissions at <https://myapps.microsoft.com/gcsnccom.onmicrosoft.com>

Cancel

Accept

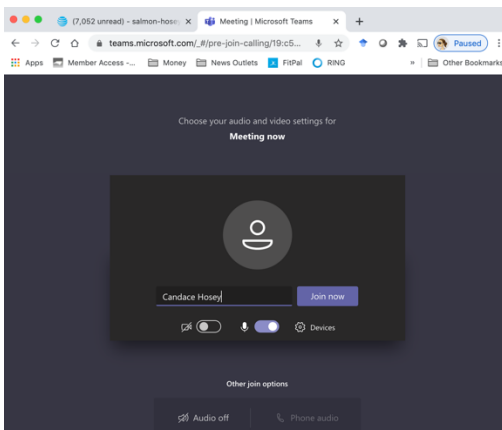
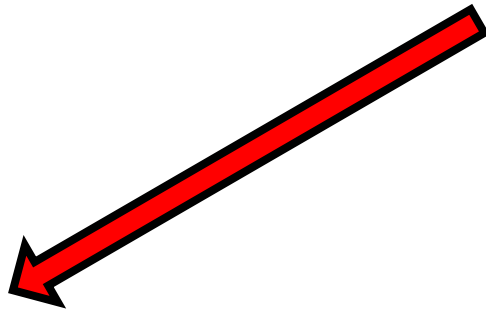

THE GUEST WILL ENTER THEIR NAME TO JOIN THE MEETING

